



Read instructions thoroughly BEFORE beginning. If using the Universal Remote Control with residential door openers, the Universal Remote Control must be used only with door openers manufactured after 1993 that utilize photoelectric sensors. The photoelectric sensors are always located on or near the bottom of the door track.

The Universal Remote Control can be programmed to activate up to two products, such as a garage door opener, gate operator, or commercial door operator. Each button on the Universal Remote Control works independently of the other and must be programmed separately. The second button on the Universal Remote Control can be programmed to different products without affecting the first button programmed. The images throughout this manual are for reference only and your product may look different.

WARNING: This product can expose you to chemicals including lead, which are known to the State of California to cause cancer or birth defects or other reproductive harm. For more information go to www.P65Warnings.ca.gov

PROGRAMMING

1 Start with your garage door, gate, or commercial door closed.

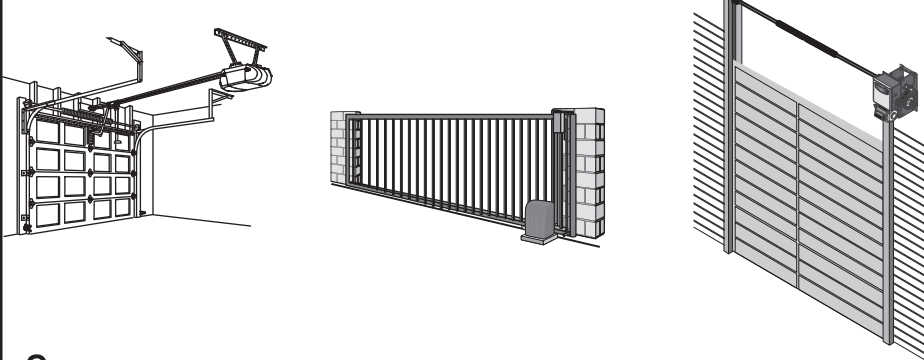

3 Press and release the SMART/LEARN button on your product.

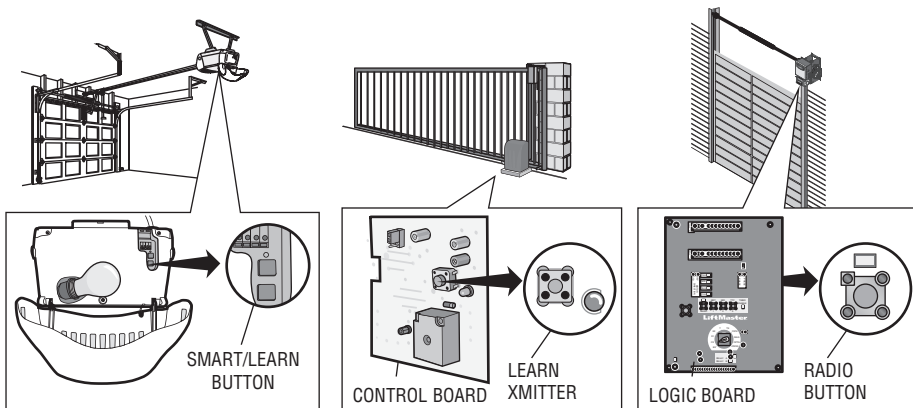

OR

Match the remote control DIP SWITCHES to the existing receiver or existing remote control.

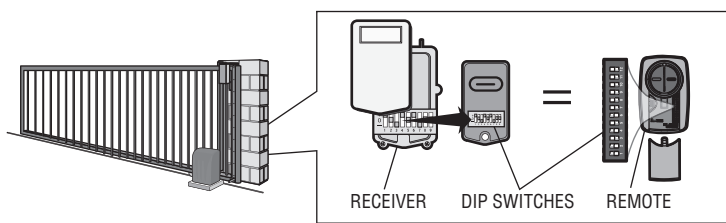

NOTE: The SMART/LEARN button or DIP SWITCHES are located either on the product or in an external receiver on or near the product. Consult your product owner's manual to locate the SMART/LEARN button or DIP SWITCHES.

NOTE: If you have a 2 position DIP SWITCH and programming fails, reverse DIP SWITCHES (OFF to ON and ON to OFF).

5 Press the program button to exit programming mode. Programming is now complete.

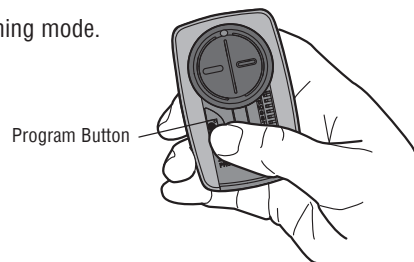

2 Open the remote control by sliding the battery cover down. Press and hold the program button until the LED lights (approximately 2 seconds).

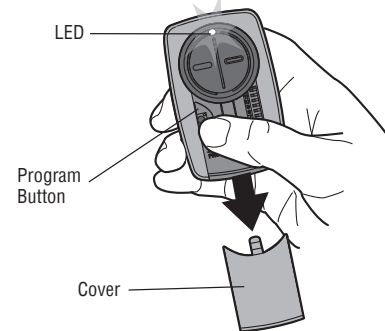

4 Press and release the button. When the LED stops flashing, continue to press and release the button until a click is heard from the garage door opener, a light on the garage door opener blinks, the garage door opens/closes, or a beep is heard from the gate operator (maximum 18 times).

OR

Press and release the Universal Remote Control button...

... 8 times	Chamberlain®* Yellow Button 2011-Current
... 3 times	Chamberlain®* Purple Button 2005-Current
... 2 times	Chamberlain®* Orange Button 1997-2005
... 4 times	Chamberlain®* Green Button 1993-1996
... 6 times	Genie Overhead Door® Intellicode 1995-Current
... 5 times	Genie Overhead Door® Intellicode 2005-Current
... 1 time	Linear® Mega-Code 1997-Current
... 7 times	Stanely® Security Code 1998
... 9 times	Wayne Dalton® Rolling Code 372.5 MHz 1999-Current
... 14 times	Linear Multicode® 10 Position Dip Switch
... 16 times	Stanley Multicode® 10 Position Dip Switch
... 18 times	Linear® 8 Position Dip Switch

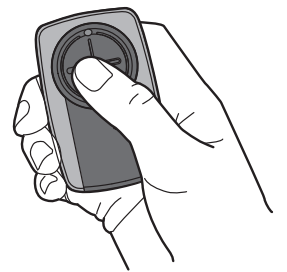

The LED on the Universal Remote Control MUST stop blinking between each press of the button. The code is accepted when a click or beep is heard, a light blinks, or the door/gate activates.

*LiftMaster, Do-It, Master Mechanic, Raynor, True Value and Sears Craftsman are compatible with Chamberlain technology.

6 Press the programmed button to activate your product. If product does not activate, repeat the programming steps 3-6 again.

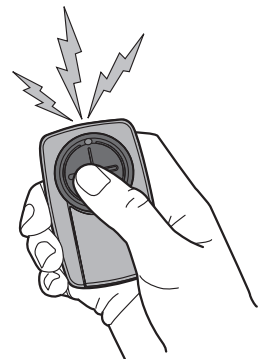

REMOTE CONTROL BATTERY

WARNING

To prevent possible SERIOUS INJURY or DEATH:

- NEVER allow small children near batteries.
- If battery is swallowed, immediately notify doctor.

To reduce risk of fire, explosion or chemical burn:

- Replace ONLY with 3V CR2032 coin batteries.
- DO NOT recharge, disassemble, heat above 212°F (100°C) or incinerate.

NOTICE: To comply with FCC and or Industry Canada (IC) rules, adjustment or modifications of this receiver and/or transmitter are prohibited, except for changing the code setting or replacing the battery. THERE ARE NO OTHER USER SERVICEABLE PARTS. Tested to Comply with FCC Standards FOR HOME OR OFFICE USE. Operation is subject to the following two conditions: (1) this device may not cause harmful interference, and (2) this device must accept any interference received, including interference that may cause undesired operation.

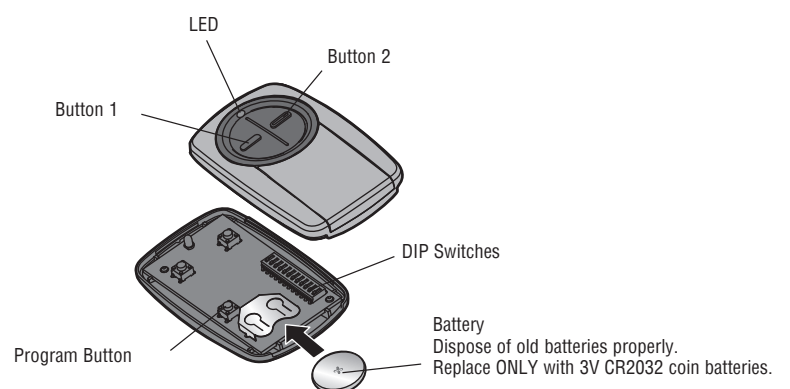

Battery
Dispose of old batteries properly.
Replace ONLY with 3V CR2032 coin batteries.

LiftMaster.com
1-800-442-1255